

Interior Design Service for

St Marks Church,
Harrogate

STYLESMITH

INTERIORS

Concept

STYLESMITH | INTERIORS



Coffee bar, servery and kitchen

STYLESMITH | INTERIORS



Servery / coffee bar INSPIRATION

- Low level curved servery in wood with panelling as per the church current panelling
- Lighting above servery
- Light Silestone work top
- Behind survey area (to match finish of servery) for self service coffee area with coffee machines and fridge for mid week groups (as 2nd / 3rd image) colour- F&B Pelt 254
- Some open storage above for cups / saucers etc as shown 4th image (painted in F&B Pelt 254)
- Replace current carpet – review designs with LVT / carpets but tonal colours
- Lighten walls with lighter paint colour – F&B Shaded white 201

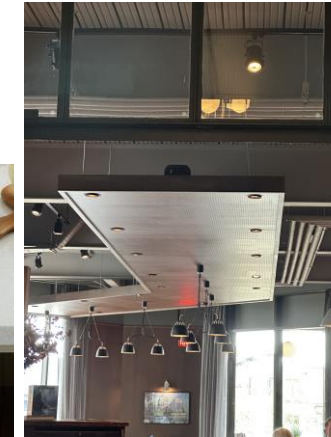

Coffee bar and shelving colour Farrow and Ball Pelt 254 (works with the St Marks colours)

Wall Colour Farrow and ball Shaded White 201





LAYOUT

- New layout moving post position

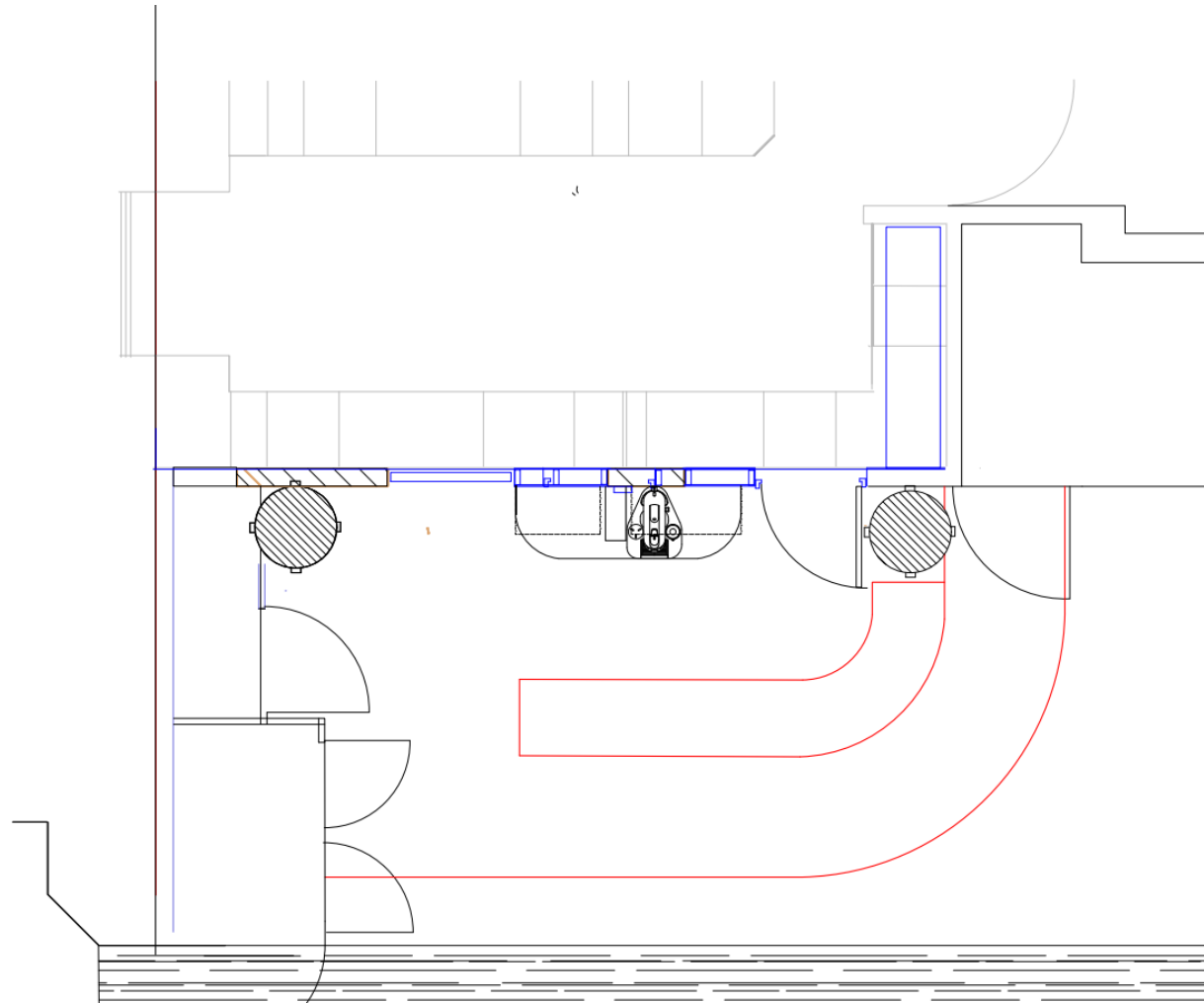

St Mark's

STYLESMITH | INTERIORS



ELEVATION

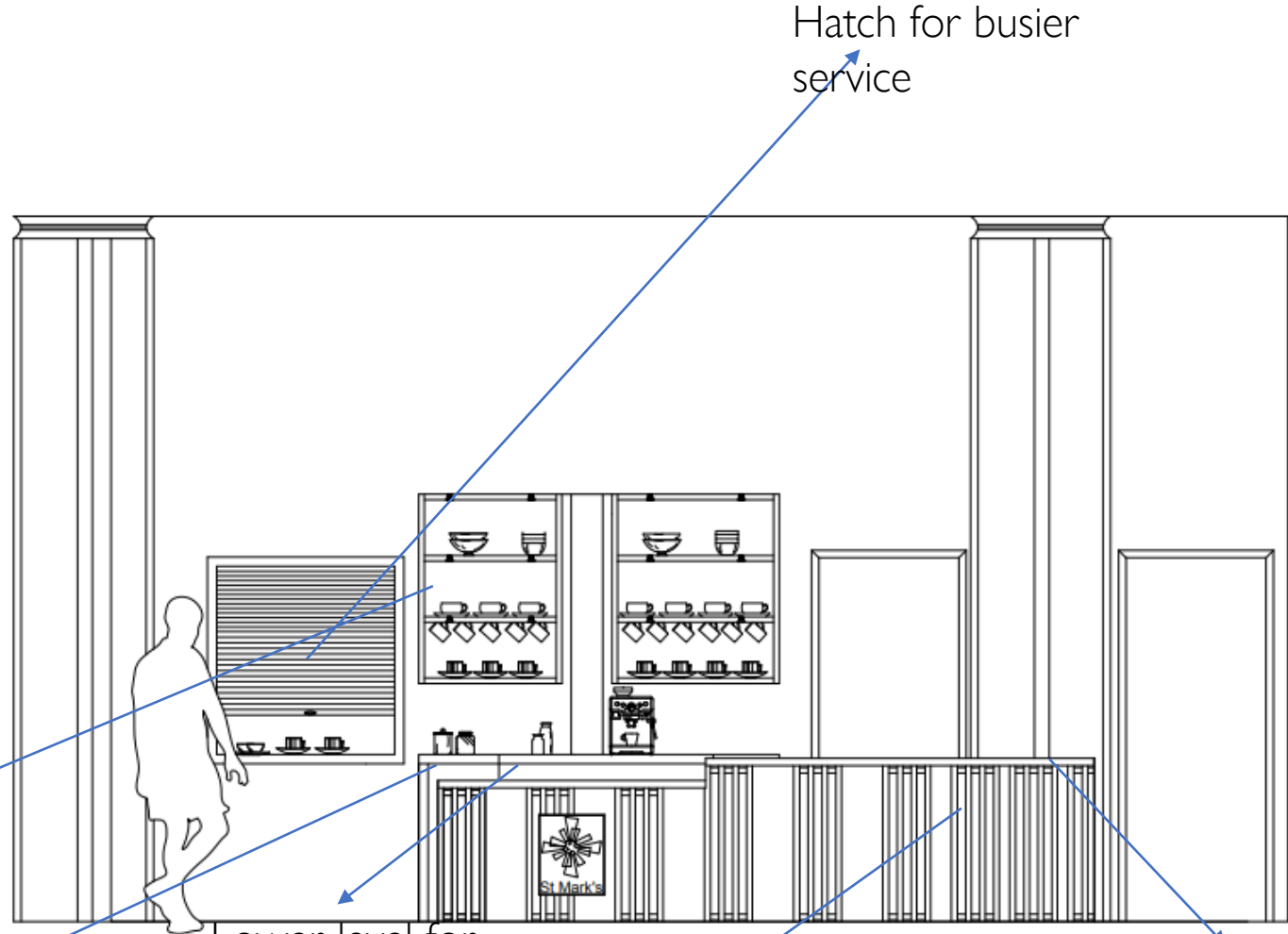

Hatch for busier service

Wooden shelving to tie in with reeded design with lighting

Fridge for milk etc for easy use for mid week groups

Lower level for children and wheel chair access

Reeded panelling to tie in with church design

Quartz work top With lighting underneath



St Mark's

STYLESMITH | INTERIORS



LAYOUT



St Mark's

STYLESMITH | INTERIORS



FLOORING

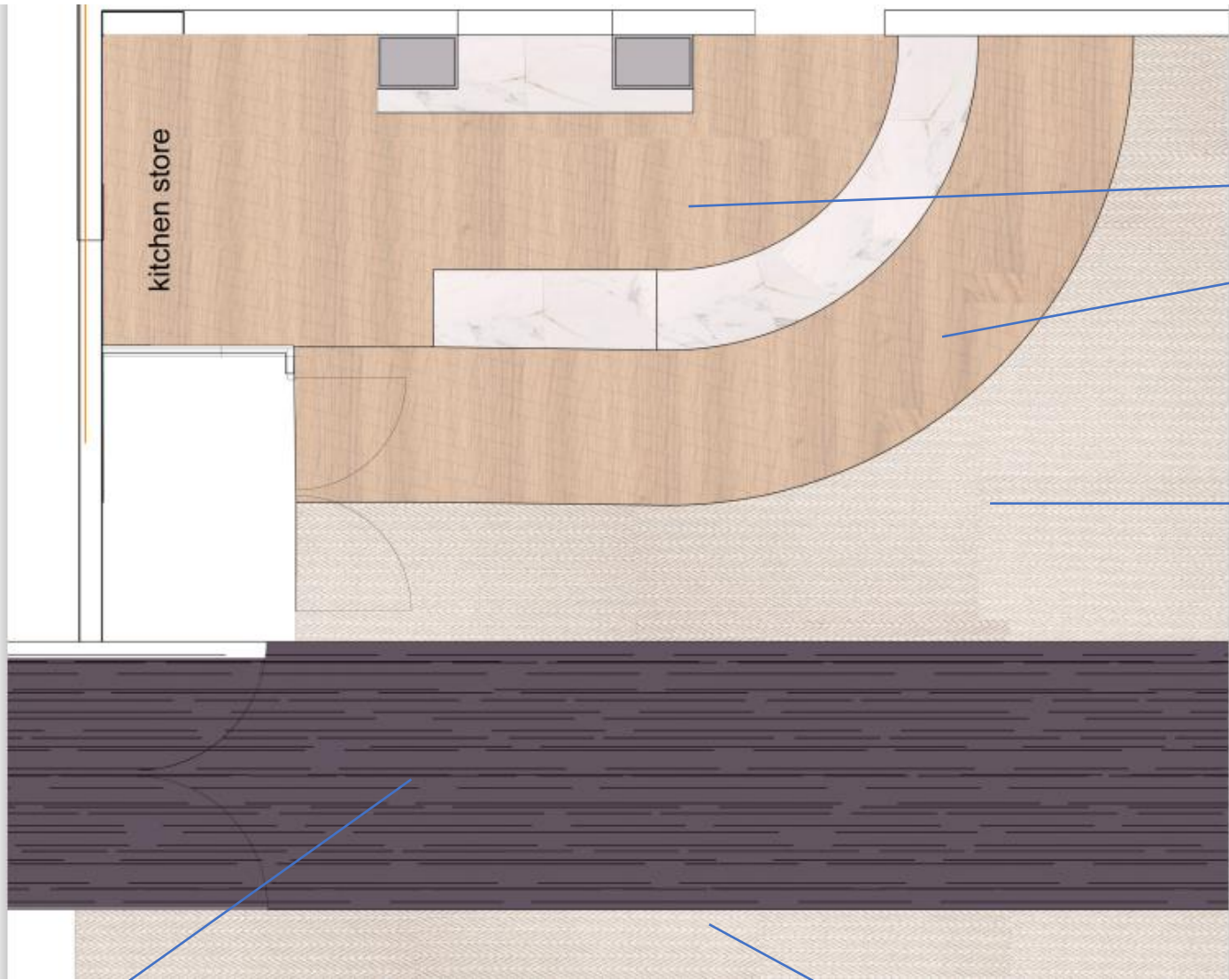

LVT flooring – practical / wood effect looking

Commercial carpet (neutral with a fleck)

Carpet (St Marks Royal Purple) leads into the main church

Commercial carpet (neutral with a fleck)



St Mark's

STYLESMITH | INTERIORS



LIGHTING

Uplift lighting on doorway and hatches

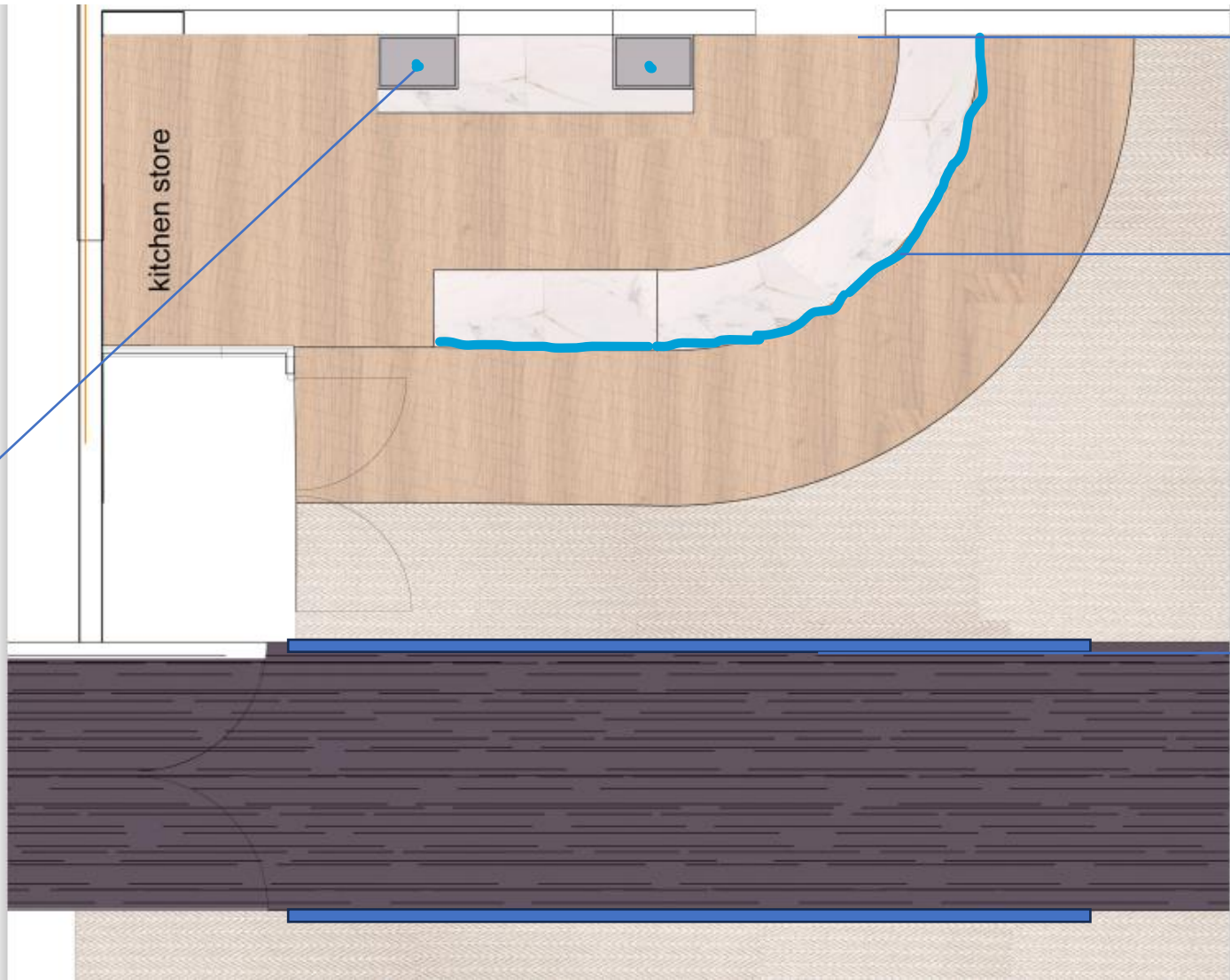

Lighting in shelves

Under work top LED strip light



Track lighting along the edge of the carpet
Warm white
Approx 14
Dimmer setting



St Mark's

STYLESMITH | INTERIORS



Kitchen INSPIRATION

- LVT flooring – easy to clean (warm wood)
- Light work tops
- Light walls
- Tiled splash back surround
- Stainless steel appliances
- Zoned areas for storage / dirty area
- Shaker styled kitchen in F&B Pelt 254 OR
- Stainless steel open kitchen
- Large sink



Warm oak LVT



Herringbone tiling



Cabinet colour



Wall colour

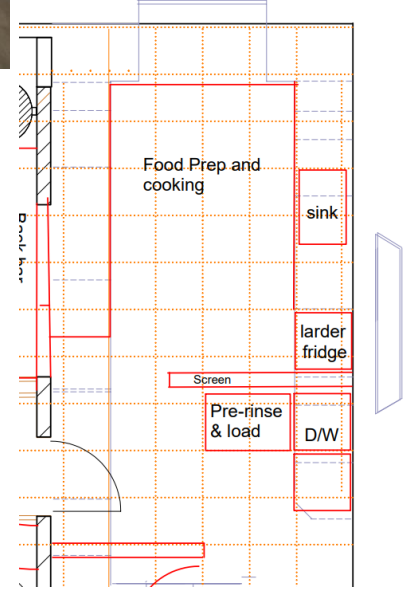



Church seating INSPIRATION

- Individual chairs – easy to move & stackable
- Carpet floor
- Zoned flooring – can add LVT

